



STUDIO BABELSBERG

# SOUND STAGES AND BACKLOTS

Production Facilities  
Office Spaces & Function Rooms  
Sets & Open Lots

JUNE 2021

SOUND STAGES AND BACKLOTS

STUDIOBABELSBERG.COM

# CONTENTS

Overview		3
Fact Sheet		4
<b>Sound Stages</b>		
Marlene-Dietrich-Halle	Stages 1, 2, 3	5
Tonkreuz	Stages 4, 5, 6, 7	6
Building 3	Stages 8, 9	7
fx.Center Babelsberg	Stages 10, 11, 12	8
TV & Media Center	Stages 14, 15, 16, 17, 22	9
Neue Film 1	Stages 18, 19	10
Neue Film 2	Stages 20, 21	11
<b>Backlots</b>		
Metropolitan Backlot		12
Exterior Green Screen		13
Water Tank		14
Suburban Train Mock-Up		15
Open Lots		16
Production Offices & Function Rooms		17
Map of Studio Babelsberg		18

# OVERVIEW

Studio Babelsberg is the oldest large-scale studio complex in the world and one of Europe's leading service providers for feature films and TV productions. Since 1912 film history has been made at Studio Babelsberg. Countless renowned filmmakers have worked with Studio Babelsberg, engaging the studio to produce legendary films. With a complete set of services that make Studio Babelsberg a one-stop-shop, the studio employs one of the best crews in the world and is well known for its unique production services, skillful set construction department and huge prop shops. Many of Germany's most famous classic films have been created at the stages and facilities of Studio Babelsberg, including Fritz Lang's *Metropolis* and Josef von Sternberg's *The Blue Angel*, starring Marlene Dietrich.

With 21 sound stages, various backlots and exterior sets on a 42-acre lot, first-class technical capabilities, highly skilled crews, attractive shooting locations nearby and its close proximity to the vibrant city of Berlin, the studio offers ideal conditions for any production need. In addition, Studio Babelsberg offers a wide variety of co-production and financing services and opportunities.



Studio Babelsberg AG  
August-Bebel-Str. 26-53  
14482 Potsdam, Germany

Eike Wolf  
Director Stage Rental & Marketing  
P +49 331 7212107  
F +49 331 7212109  
[StageRental@StudioBabelsberg.com](mailto:StageRental@StudioBabelsberg.com)

[StudioBabelsberg.com](http://StudioBabelsberg.com)

# FACT SHEET

stage	length x width (m)	length x width (ft)	total area (m <sup>2</sup> )	total area (sq ft)	max. height (m)	max. height (ft)
1	55.84 x 29.80	183 x 98	1,664	17,911	13.00	43
2	56.80 x 36.50	186 x 120	2,073	22,316	14.00	46
3	55.80 x 29.80	183 x 98	1,662	17,890	14.30	47
4	30.00 x 20.00	98 x 66	600	6,458	9.90	32
5	30.00 x 20.00	98 x 66	600	6,458	10.10	33
6	25.00 x 18.00	82 x 59	450	4,844	9.00	30
7	25.00 x 18.00	82 x 59	450	4,844	9.00	30
8	34.70 x 19.00	114 x 62	659	7,097	7.70	25
9	34.70 x 19.00	114 x 62	659	7,097	7.70	25
10	27.20 x 21.20	89 x 70	577	6,207	10.0	33
11	22.00 x 16.60	72 x 54	365	3,931	7.90	26
12	16.20 x 10.70	53 x 35	173	1,866	6.00	20
14	33.30 x 22.20	109 x 73	739	7,957	11.50	38
15	33.30 x 22.20	109 x 73	739	7,957	11.50	38
16	33.30 x 22.20	109 x 73	739	7,957	11.50	38
17	33.30 x 22.20	109 x 73	739	7,957	11.50	38
18	98.80 x 19.98	324 x 66	1,974	21,248	9.10	30
19	71.80 x 59.90	236 x 196	5,574	59,998	11.50	38
20	144.65 x 48.70	474 x 160	7,044	75,826	10.30	34
21	49.40 x 24.00	162 x 79	1,185	12,751	10.20	33
22	25.75 x 38.75	84.5 x 127	1,000	10,764	11,00	36

Backlot	size (m <sup>2</sup> )	size (acres)
Metropolitan Backlot	15,000	3.7
Open Lots	36,000	9.0
Exterior Green Screen	663	0.15
with adjacent backlot	6,000	1.48

# MARLENE-DIETRICH-HALLE

Built for Fritz Lang's *Metropolis* in 1926, Marlene-Dietrich-Halle has been home to numerous film classics including *The Blue Angel*. With its total area of 60,000 sq ft and its 46 ft ceiling, Marlene-Dietrich-Halle counts among Europe's largest sound stages – an ideal location for feature film production. The complex is divided into three stages, 22,316 sq ft Stage 2 and two additional stages, offering 17,890 sq ft and 17,911 sq ft. All three stages also feature built-in water pools, which can be easily filled on request.

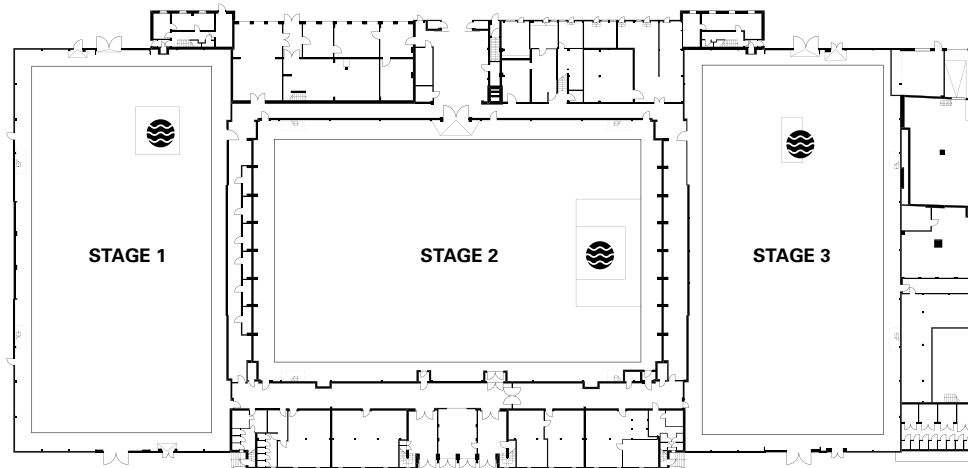
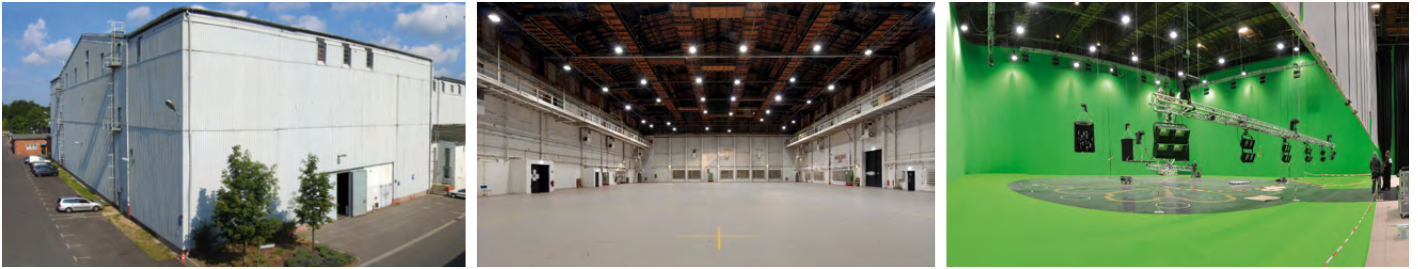

 Water pool

## STAGE 1 Große Süd

length x width	55.84 m x 29.80 m	183 ft x 98 ft
working height	12.50 m	41.00 ft
total area	1,664 m <sup>2</sup>	17,911 sq ft
max. height	13.00 m	43 ft

## STAGE 3 Große Nord

length x width	55.80 m x 29.80 m	183 ft x 98 ft
working height	12.50 m	41.00 ft
total area	1,662 m <sup>2</sup>	17,890 sq ft
max. height	14.30 m	47 ft

## STAGE 2 Mittelhalle

length x width	56.80 m x 36.50 m	186 ft x 120 ft
working height	12.50 m	41.00 ft
total area	2,073 m <sup>2</sup>	22,316 sq ft
max. height	14.00 m	46 ft

total area sound stages 5,400 m<sup>2</sup> / 58,117 sq ft    total area offices and function rooms 420 m<sup>2</sup> / 4,521 sq ft

# TONKREUZ

When it was built in 1929, Tonkreuz set groundbreaking standards in film production with its revolutionary design. Today, the historical building is a high-tech film and TV stage complex with four modern, air-conditioned sound stages which are characterized by excellent sound insulation.

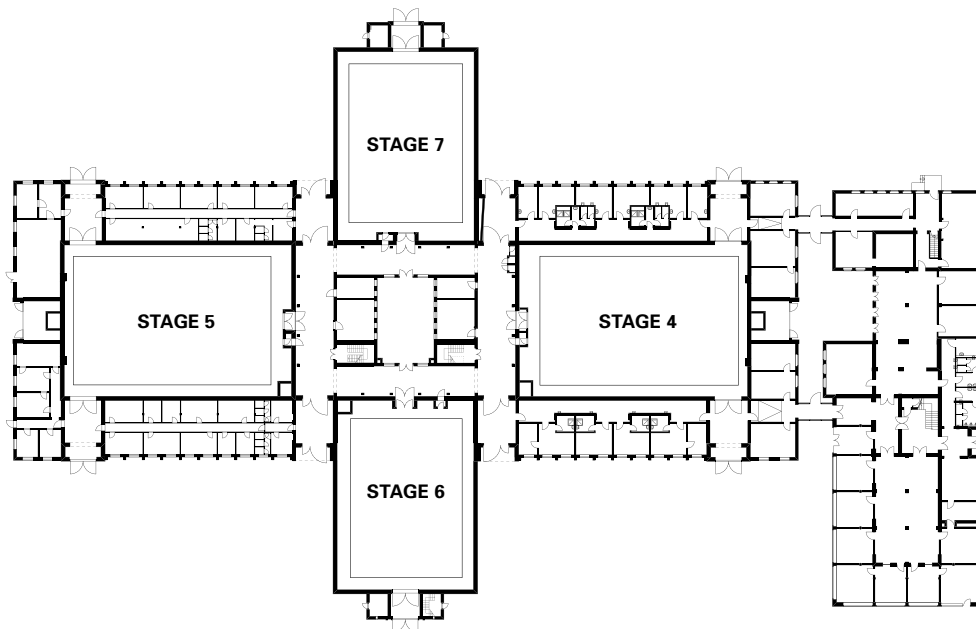

## STAGE 4 Ton Nord

length x width	30.00 m x 20.00 m	98 ft x 66 ft
working height	7.75 m	25.42 ft
total area	600 m <sup>2</sup>	6,458 sq ft
max. height	9.90 m	32 ft

## STAGE 6 Ton Ost – Tom-Zickler-Halle

length x width	25.00 m x 18.00 m	82 ft x 59 ft
working height	6.90 m	22.63 ft
total area	450 m <sup>2</sup>	4,844 sq ft
max. height	9.00 m	30 ft

## STAGE 5 Ton Süd

length x width	30.00 m x 20.00 m	98 ft x 66 ft
working height	7.75 m	25.42 ft
total area	600 m <sup>2</sup>	6,458 sq ft
max. height	10.10 m	33 ft

## STAGE 7 Ton West

length x width	25.00 m x 18.00 m	82 ft x 59 ft
working height	6.90 m	22.63 ft
total area	450 m <sup>2</sup>	4,844 sq ft
max. height	9.00 m	30 ft

# BUILDING 3

Located in Building 3, Stage 8 and Stage 9 provide 14,194 sq ft of floor space in total and 7,097 sq ft each. Both air-conditioned stages can be equipped with additional state-of-the-art technology such as lighting rigs and lighting control systems. In addition, the complex features offices, workshops, conference rooms and service areas on three floors.

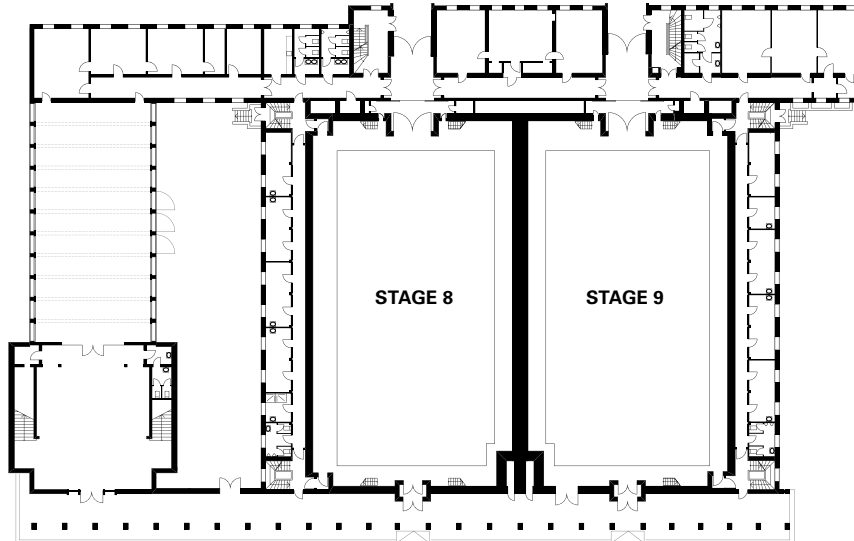

## STAGE 8 Neue West

length x width	34.70 m x 19.00 m	114 ft x 62 ft
working height	6.00 m	19.68 ft
total area	659 m <sup>2</sup>	7,097 sq ft
max. height	7.70 m	25 ft

## STAGE 9 Neue Ost

length x width	34.70 m x 19.00 m	114 ft x 62 ft
working height	6.00 m	19.68 ft
total area	659 m <sup>2</sup>	7,097 sq ft
max. height	7.70 m	25 ft

# FX.CENTER BABELSBERG

Located in the high-tech fx.Center complex, Stage 10 is equipped with a 360° green screen for VFX. Stage 11 is custom-designed for SFX, offering a powerful ventilation system for pyrotechnic effects and a strong drainage system for filming with water. Stage 12 houses Volucap, the first volumetric video studio on the European continent, located on 1,866 sq ft and equipped with 32 cameras for state-of-the-art VR and AR projects using '3D Human Body Reconstruction' software. In addition, fx.Center features two cinema auditoriums, conference rooms and rent areas to host special events.

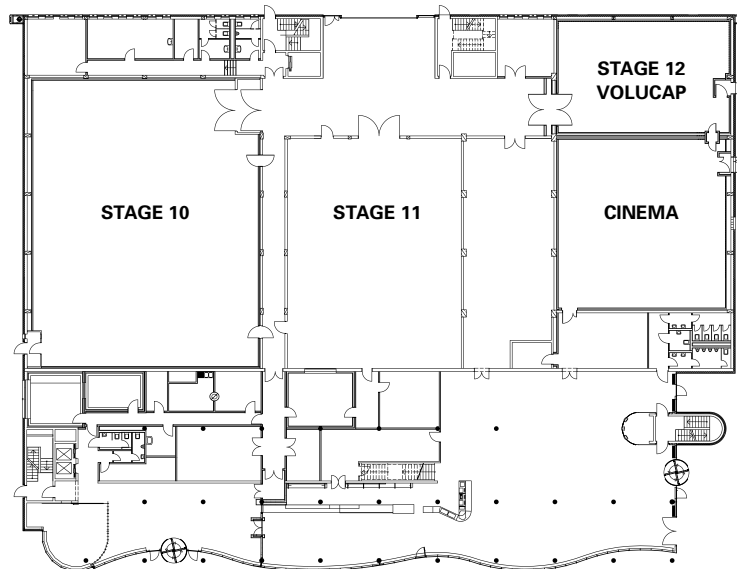

## STAGE 10 fx1

length x width	27.20 m x 21.20 m	89 ft x 70 ft
working height	7.50 m	24.60 ft
total area	577 m <sup>2</sup>	6,207 sq ft
max. height	10.0 m	33 ft

## STAGE 12 Volucap

Volumetric capture studio		
total area	173 m <sup>2</sup>	1,866 sq ft

## STAGE 11 fx2

length x width	22.00 m x 16.60 m	72 ft x 54 ft
working height	7.50 m	24.60 ft
total area	365 m <sup>2</sup>	3,931 sq ft
max. height	7.90 m	26 ft

## CINEMA

seats	155	
screen size	11.2 m x 4.70 m	120 ft x 15.40 ft
area	16.10 m x 15.90 m	52.30 ft x 52.20 ft



# TV & MEDIA CENTER

The TV & Media Center includes five stages with a total area of 43,000 sq ft as well as production offices on two floors.

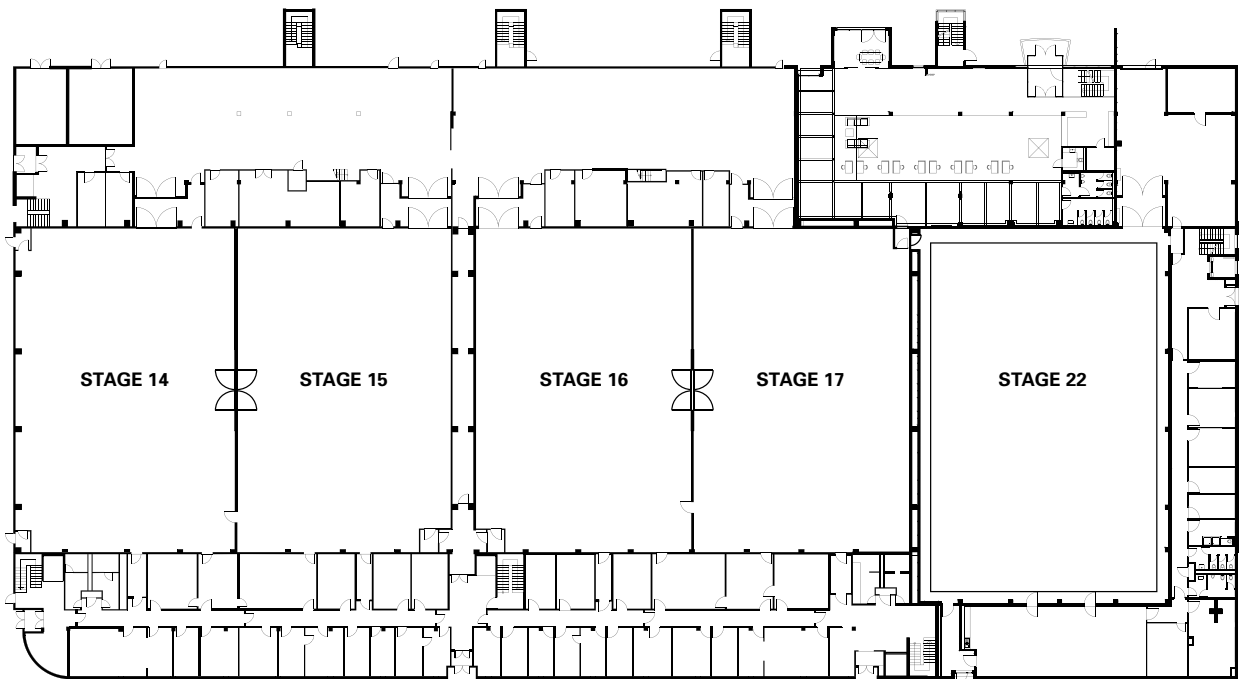

## STAGE 14 + 15

length x width	33.30 m x 22.20 m	109 ft x 73 ft
working height	10 m	32.80 ft
total area	739 m <sup>2</sup>	7,957 sq ft
max. height	11.50 m	38 ft

## STAGE 17

length x width	33.30 m x 22.20 m	109 ft x 73 ft
working height	10 m	32.80 ft
total area	739 m <sup>2</sup>	7,957 sq ft
max. height	11.50 m	38 ft

## STAGE 16

length x width	33.30 m x 22.20 m	109 ft x 73 ft
working height	10 m	32.80 ft
total area	739 m <sup>2</sup>	7,957 sq ft
max. height	11.50 m	38 ft

## STAGE 22

length x width	25.75 m x 38.75 m	84.5 ft x 127 ft
working height	11.00 m	36 ft
total area	1,000 m <sup>2</sup>	10,764 sq ft
max. height	11.00 m	36 ft

# NEUE FILM 1

The complexes Neue Film 1 and Neue Film 2 are located in close proximity to the main studio lot. The original facades of the former factory buildings have been maintained and can also be used as a unique industrial backdrop. The large-scale stages are suitable for extensive sets for any film or TV production. Directly adjoining are the production offices and function rooms as well as workshops and storage space for prefabrication, props and decoration.

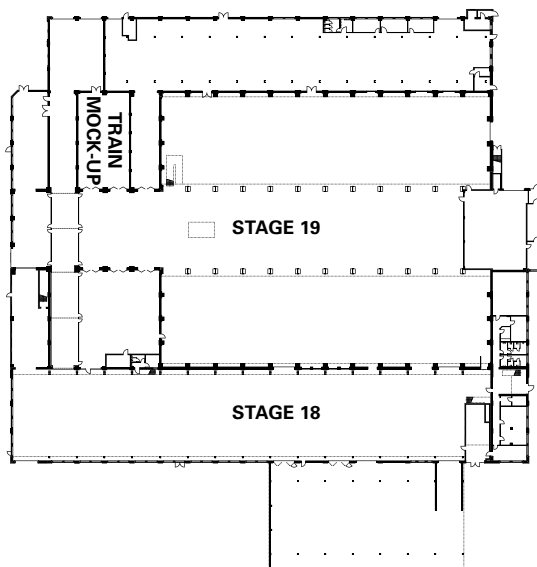

## STAGE 18

length x width	98.80 m x 19.98 m	324 ft x 66 ft
working height	7.50 m	24.60 ft
total area	1,974 m <sup>2</sup>	21,248 sq ft
max. height	9.10 m	30 ft

## STAGE 19

length x width	71.80 m x 59.90 m	236 ft x 196 ft
working height	9.10 m	29.85 ft
total area	5,574 m <sup>2</sup>	59,998 sq ft
max. height	11.50 m	38 ft

## OFFICES AND FUNCTION ROOMS

offices	526 m <sup>2</sup>	5,662 sq ft
workshop and storage rooms	3,480 m <sup>2</sup>	37,459 sq ft
gallery space	1,430 m <sup>2</sup>	15,393 sq ft

## SUBURBAN TRAIN MOCK-UP

length x width	18.00 m x 3.10 m	59 ft x 10 ft
----------------	------------------	---------------

# NEUE FILM 2

Neue Film 2 is our largest studio complex offering a total of 88,576 sq ft of floor space. It also features Germany's largest indoor water tank for surface and underwater filming.

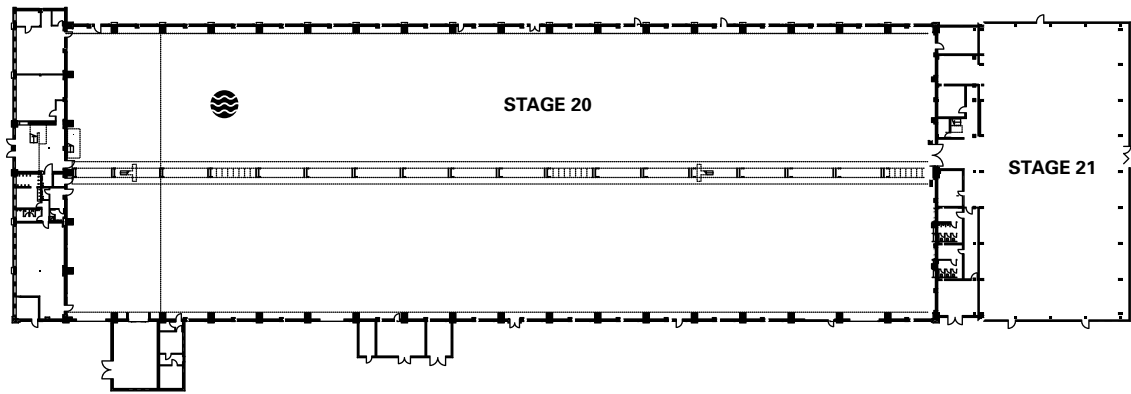

 Water tank

## STAGE 20 Rainbow Stage

length x width	144.65 m x 48.70 m	474 ft x 160 ft
working height	7.90 m	25.91 ft
total area	7,044 m <sup>2</sup>	75,826 sq ft
max. height	10.30 m	34 ft

## STAGE 21

length x width	49.40 m x 24.00 m	162 ft x 79 ft
working height	7.50 m	24.60 ft
total area	1,185 m <sup>2</sup>	12,751 sq ft
max. height	10.20 m	33 ft

## WATER TANK

Please see page 14 for details and specifications

# METROPOLITAN BACKLOT

The Metropolitan Backlot set at Studio Babelsberg is among the most extensive in Europe. Four street settings in different architectural styles meet a wide range of locations, be it New York, London, Berlin or Paris. From modern urban areas to historic backdrops, the backlot can be modified and customized thanks to its flexible modular construction, green and blue screen elements as well as digital set extensions.

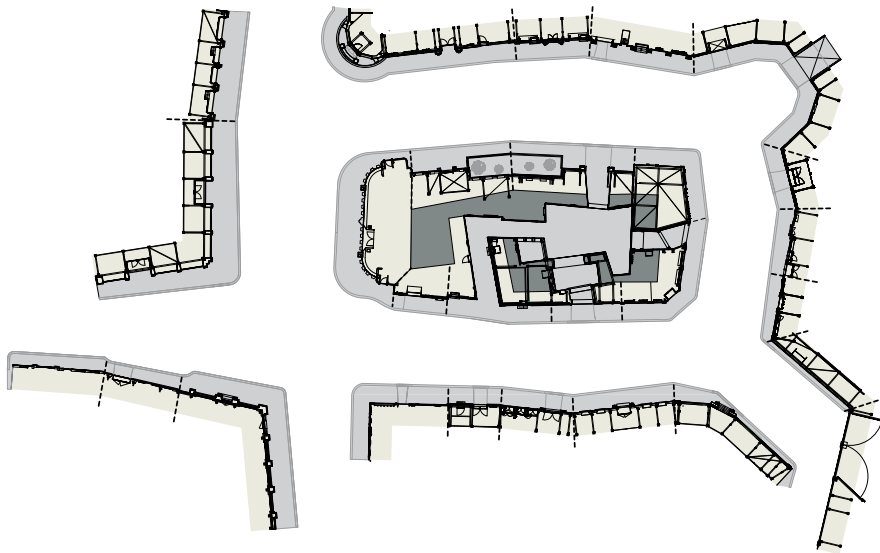

## TECHNICAL DATA

- 8,400 m<sup>2</sup> (2 acres) facades
- 5,500 m<sup>2</sup> (1.2 acres) cobbled and asphalt streets
- 2,500 m<sup>2</sup> (27.007 sq ft) scaffold structures for set extensions
- 12-15 m (39.4 - 49.2 ft) high
- Easy access to power and water
- Suitable for vehicles of up to 20 t
- 54 facades
- 600 doors and windows
- Several interiors and dividable courtyard

For more information on the Metropolitan Backlot please [visit metropolitanbacklot.com](http://metropolitanbacklot.com) or [download our booklet](#).

# EXTERIOR GREEN SCREEN

We offer one of the largest exterior green screen walls in Europe for green screen, blue screen and VFX shooting. The weatherproof, permanent green screen wall measures 7,104 sq ft (663 m<sup>2</sup>) and is located on our backlot in the immediate proximity to our stages. You can also rent the adjacent backlot area with 64,583 sq ft (6,000 m<sup>2</sup>) for film, TV and commercial productions as well as for photo shoots.

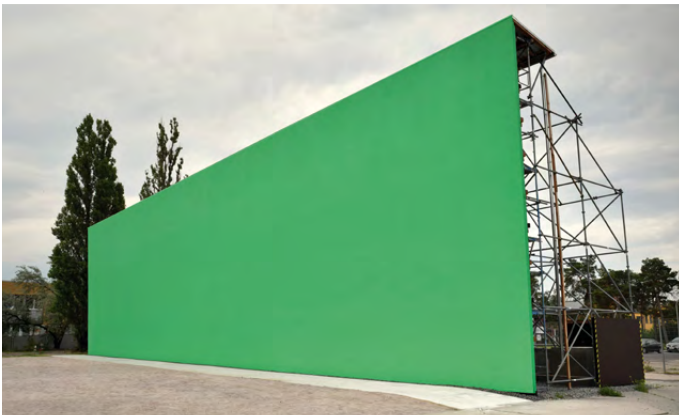
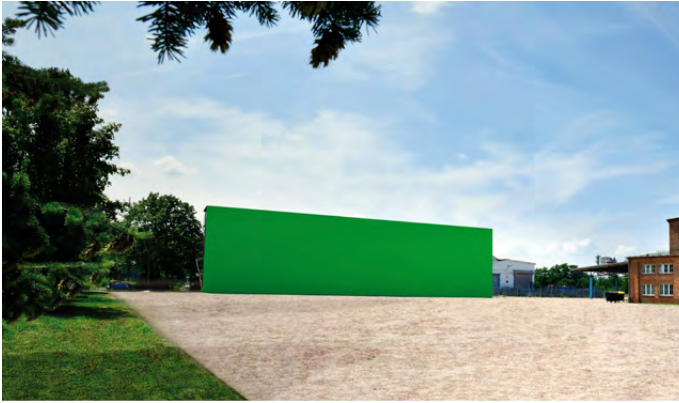

## GREEN SCREEN WALL

dimensions	63.2 m x 10.5 m	207.3 ft x 34.4 ft
------------	-----------------	--------------------

## ADJACENT CONCRETE AREA

length x width	52 m x 20 m	170.6 ft x 65.6 ft
total area	1,040 m <sup>2</sup>	11,194 sq ft

## TOTAL BACKLOT

length x width	120 m x 50 m	394 ft x 164 ft
total area	6,000 m <sup>2</sup>	64,583 sq ft

# WATER TANK

The water tank can hold up to 500,000 litres at 4 m depth, which makes it the largest in Germany. Whether single underwater shots or demanding action sequences: The water tank can be used for film, TV and commercial productions of any scope and complexity. For set construction above and under water, our Art Department is available at any time. We can also provide highly trained underwater crews, lighting technicians, stunt crews and safety divers.

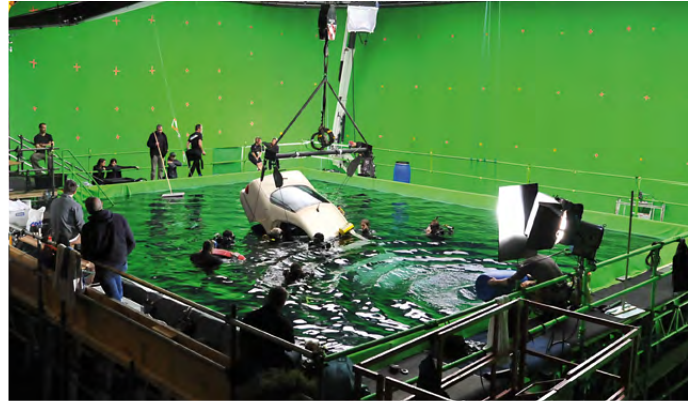

## WATER TANK

dimensions	11.00 m x 12.00 m	36 ft x 39 ft
max. water depth	4.00 m	13.12 ft

## TECHNICAL DATA

- Catwalk/walkway around the tank
- Permanent heating installation up to 33°C (91.4°F) water temperature
- Permanent filtering and automatic pH-value regulation
- Potential equalisation
- Water management office certificate

## ON DEMAND

- Green Screen
- Skilled electricians and camera teams

# SUBURBAN TRAIN MOCK-UP

We offer a full-sized mock-up of a modern suburban train with an adjacent passenger platform. The scale model of the passenger car is very realistic with its exterior and interior design and front end and side views. The design of the entrance areas and the fully equipped passenger compartments can be modified on request, transforming it into any regional rail or subway. While the vehicle body is made of wood, the interior is mainly built from original parts including seats, handrails, lighting, and flooring. Individual doors are fully functional and equipped with acoustic and visual signals.



## SUBURBAN TRAIN MOCK-UP

size (l x w) 18.00 m x 3.10 m 59 ft x 10 ft

# OPEN LOTS

The spacious backlots outside our studios offer a wide range of existing sets and space for new construction in the immediate proximity to our sound stages, production offices and workshops. Adjacent to our studios Neue Film 1 and Neue Film 2 we offer a 9-acre open lot for exterior filming and the construction of custom-built sets.





# PRODUCTION OFFICES & FUNCTION ROOMS

Studio Babelsberg provides multiple modern and flexible production facilities for every department including make-up and hair rooms, dressing rooms and wardrobe, spacious storage and office space. All production offices and function rooms are located directly adjacent to the stages. From basic furnished offices to fully equipped facilities, we can meet any budget requirement and provide additional features on request.





Studio Babelsberg AG  
 August-Bebel-Strasse 26-53, 14482 Potsdam  
 StudioBabelsberg.com

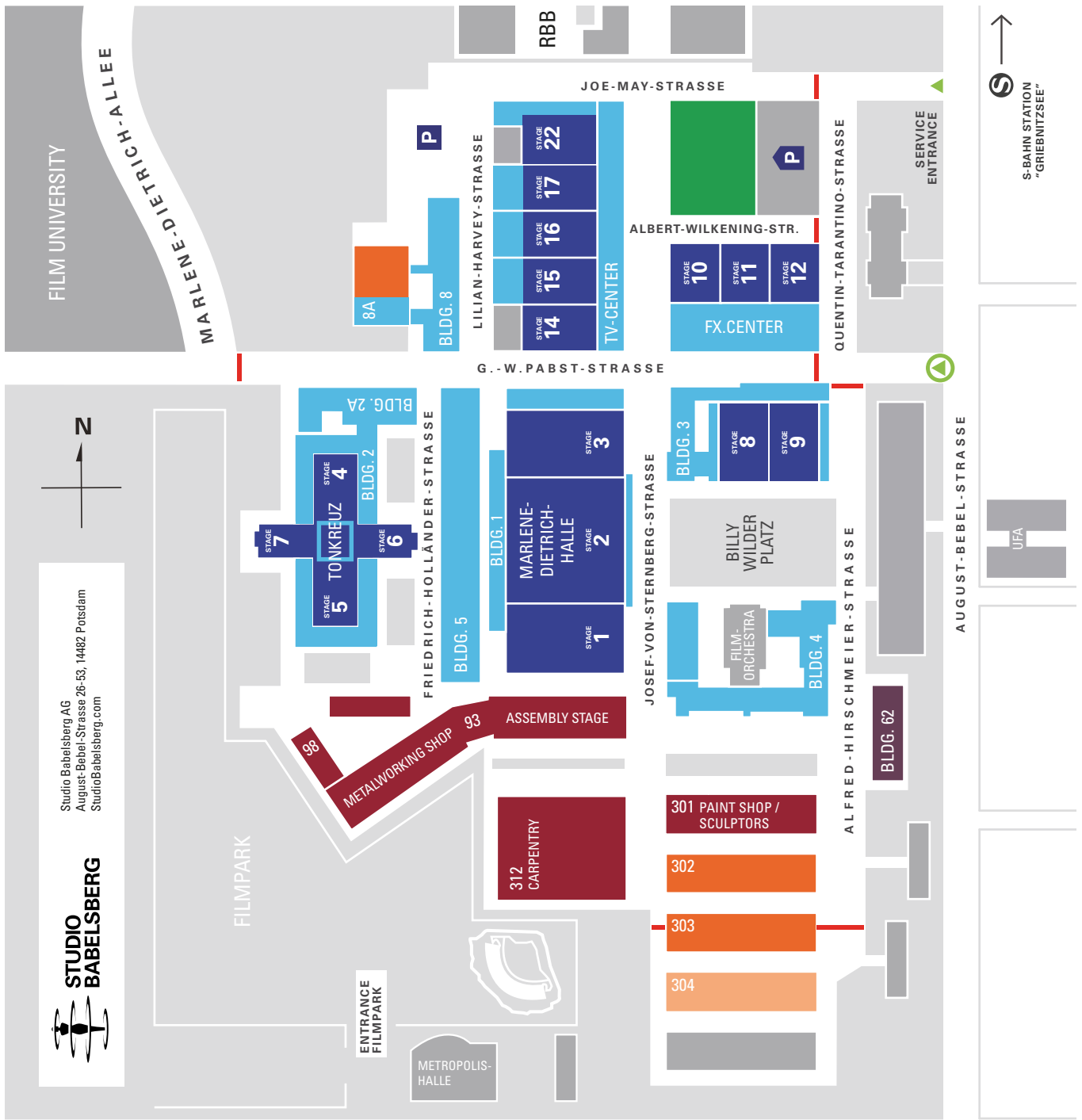

**DB**  
 TRAIN STATION  
 "MEDIENSTADT BABELSBERG"



- STAGES
- BACKLOTS
- MANAGEMENT
- ART DEPARTMENT / CONSTRUCTION
- PROP SHOPS
- COSTUME DEPARTMENT
- OFFICES / SUPPORT ROOMS
- ▲ MAIN ENTRANCE
- ▲ GATE
- P PARKING
- P PARKING GARAGE
- LIMITED ACCESS

**S**  
 S-BAHN STATION  
 "GRIEBNITZSEE"



AUGUST-BEBEL-STRASSE



AUGUST-BEBEL-STRASSE



AUGUST-BEBEL-STRASSE



AUGUST-BEBEL-STRASSE



AUGUST-BEBEL-STRASSE



AUGUST-BEBEL-STRASSE



AUGUST-BEBEL-STRASSE



AUGUST-BEBEL-STRASSE



AUGUST-BEBEL-STRASSE



AUGUST-BEBEL-STRASSE



AUGUST-BEBEL-STRASSE



AUGUST-BEBEL-STRASSE



AUGUST-BEBEL-STRASSE



AUGUST-BEBEL-STRASSE



AUGUST-BEBEL-STRASSE



AUGUST-BEBEL-STRASSE



AUGUST-BEBEL-STRASSE



AUGUST-BEBEL-STRASSE



AUGUST-BEBEL-STRASSE



AUGUST-BEBEL-STRASSE



AUGUST-BEBEL-STRASSE



AUGUST-BEBEL-STRASSE



AUGUST-BEBEL-STRASSE



AUGUST-BEBEL-STRASSE



AUGUST-BEBEL-STRASSE



AUGUST-BEBEL-STRASSE



AUGUST-BEBEL-STRASSE



AUGUST-BEBEL-STRASSE



AUGUST-BEBEL-STRASSE



AUGUST-BEBEL-STRASSE



AUGUST-BEBEL-STRASSE



AUGUST-BEBEL-STRASSE



AUGUST-BEBEL-STRASSE



AUGUST-BEBEL-STRASSE



AUGUST-BEBEL-STRASSE



AUGUST-BEBEL-STRASSE



AUGUST-BEBEL-STRASSE



AUGUST-BEBEL-STRASSE



AUGUST-BEBEL-STRASSE



AUGUST-BEBEL-STRASSE



AUGUST-BEBEL-STRASSE



AUGUST-BEBEL-STRASSE



AUGUST-BEBEL-STRASSE



AUGUST-BEBEL-STRASSE



AUGUST-BEBEL-STRASSE



AUGUST-BEBEL-STRASSE



AUGUST-BEBEL-STRASSE



AUGUST-BEBEL-STRASSE



AUGUST-BEBEL-STRASSE



AUGUST-BEBEL-STRASSE



AUGUST-BEBEL-STRASSE



AUGUST-BEBEL-STRASSE



AUGUST-BEBEL-STRASSE



AUGUST-BEBEL-STRASSE



AUGUST-BEBEL-STRASSE



AUGUST-BEBEL-STRASSE



AUGUST-BEBEL-STRASSE



AUGUST-BEBEL-STRASSE



AUGUST-BEBEL-STRASSE



AUGUST-BEBEL-STRASSE



AUGUST-BEBEL-STRASSE



AUGUST-BEBEL-STRASSE



AUGUST-BEBEL-STRASSE



AUGUST-BEBEL-STRASSE



AUGUST-BEBEL-STRASSE



AUGUST-BEBEL-STRASSE



AUGUST-BEBEL-STRASSE

